



PALACONGRESSI  
DI RIMINI

ITALIAN EXHIBITION GROUP  
*Facilitating the future*

# FONTANA ROOM

TECHNICAL SHEET





## MAIN CHARACTERISTICS

The room can be used as a slide centre or press room. The large central table can accommodate up to 16 workstations, separated by removable desk partitions, which can easily be transformed into a boardroom.

The room has lockable storage cabinets and Italian style Moroso upholstered chairs. The room is located on the first floor.

## FEATURES:

- Natural light and remote controlled blackout facilities
- Dimmer lights for selected areas
- Audio amplification system with wired and radio microphones
- Screen and hanging video projection system for front screen projection
- Electrical connections and internet sockets in underfloor outlet boxes or wall outlets
- High density Wi-Fi coverage
- 2 entrance points to the room
- Customisable digital signage at the entrance to room

### The origin of the name

With its sinuous shape reflecting the architecture of Medieval times, the Pigna Fountain characterises Piazza Cavour. As symbol of abundance, the pine cone, replacing a sculpture of St. Paul, was placed on top of the fountain by the French in the turbulent Napoleonic times. When Leonardo da Vinci came to Rimini in 1502 with Cesare Borgia, he was fascinated by the sound of the running water from the various spouts, which later inspired him to invent a unique water organ. As in past centuries, the fountain is still a source of drinkable water for all.

# FONTANA ROOM

FIRST FLOOR

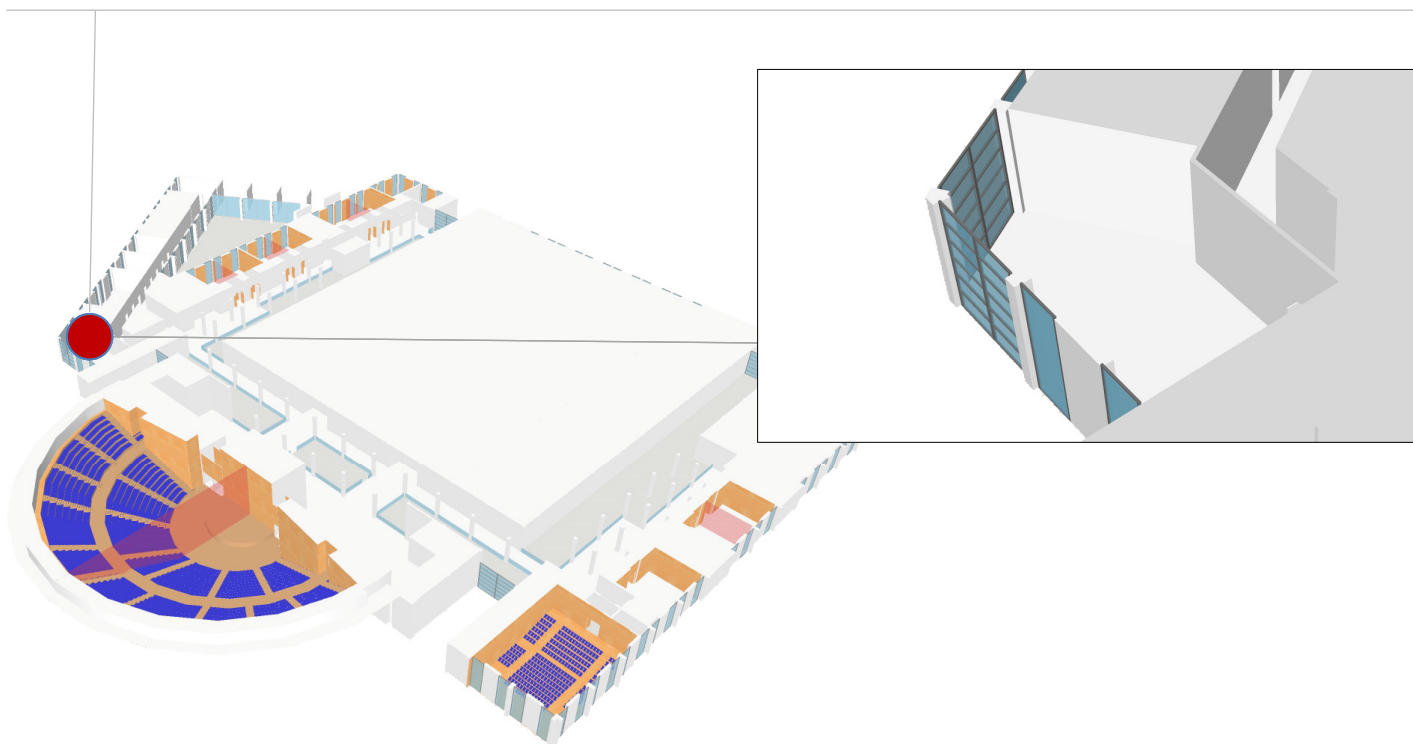

## TECHNICAL DATA

Height (m)	Area m2	Size (m)	Full room capacity	Classroom style	Horseshoe style	Boardroom style	Table service	Cocktail service
4.20	112	16.10 x 8.25 approx	-	-	14	16	-	-

## TECHNICAL INFORMATION

Floor weight capacity	Hanging fixtures permitted	Flooring	Walls	Ceiling	Natural light	Blackout facilities
400	NO	DARK CHERRY WOOD	WHITE WALLS	PIERCED WHITE PLASTERBOARD	YES	YES

VIRTUAL TOUR LINK - take a 360° virtual tour of the Fontana Room at <https://en.riminipalacongressi.it/spaces/virtual-tour>

# FONTANA ROOM

FIRST FLOOR

## PHOTOGALLERY



Palacongressi di Rimini - Via della Fiera 23 - 47923 Rimini - Tel +39 0541 711500 - Fax +39 0541 711505

[info@riminipalacongressi.it](mailto:info@riminipalacongressi.it) - [www.riminipalacongressi.it](http://www.riminipalacongressi.it)

ITALIAN EXHIBITION GROUP  
Providing the future