

SQUERO ROOM

TECHNICAL SHEET





MAIN CHARACTERISTICS

Situated in a reserved area of the venue, this room can be used as a back office for the administrative or operational activities of conferences/events, such as secretariat, production office, staffroom or for board, committee or presidential meetings. Standard, ready to go set up and lay out. Thonet linking lecture chairs with maximum comfort can be provided.

The room is located on the first floor.

FEATURES:

- Natural light and remote controlled blackout facilities
- Dimmer lights for selected areas
- Presidential table and podium
- Audio amplification system with wired and radio microphones
- Screen and hanging video projection system for front screen projection
- Electrical connections and internet sockets in underfloor outlet boxes or wall outlets
- Fixed video production
- High density Wi-Fi coverage
- LCD monitor on both Presidential table and podium
- 2 entrance points to the room
- Customisable digital signage at entrance to room

The origin of the name

The Squero Room takes its name from the slipway of the shipyards in the areas of the northern Adriatic coast. These yards were filled with the wooden skeletons of ships and boats that slowly came to life at the hands of the skilled craftsmen. Situated on the left bank of the port, today it is where the boats are hauled up for maintenance.

SQUERO ROOM

FIRST FLOOR

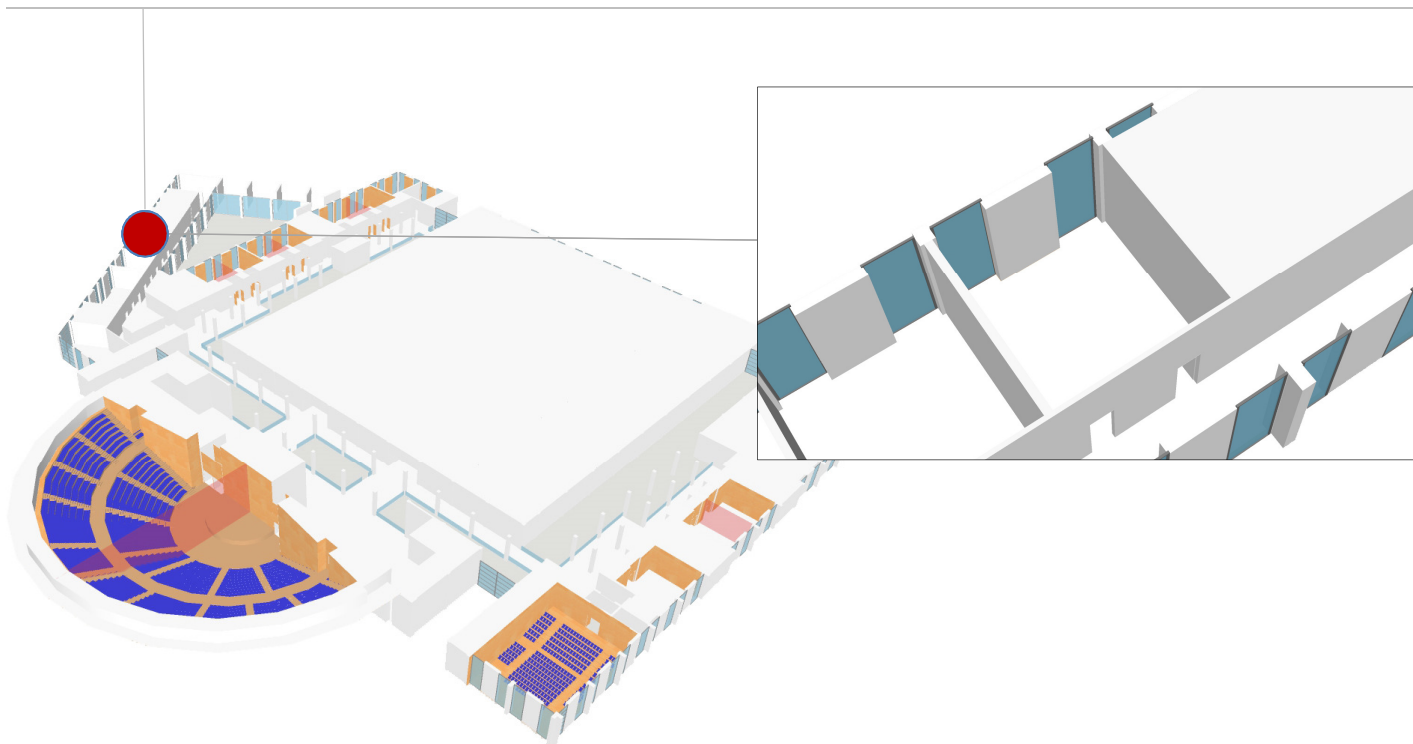

TECHNICAL DATA (first floor exhibit areas)

Height (m)	Area m2	Size (m)	Full room capacity	Classroom style	Horseshoe style	Boardroom style	Table service	Cocktail service
4.20	61.15	7.50 x 8.15	40	21	15	20	32	50

TECHNICAL INFORMATION

Floor weight capacity	Hanging fixtures permitted	Flooring	Walls	Ceilings	Natural light	Blackout facilities
400	YES	DARK CHERRY WOOD	WHITE	PIERCED WHITE PLASTERBOARD	YES	YES

VIRTUAL TOUR LINK - take a 360° virtual tour of the Squero Room at <https://en.riminipalacongressi.it/spaces/virtual-tour>

PHOTOGALLERY

