



PONTE ROOM

TECHNICAL SHEET





MAIN CHARACTERISTICS

Elegant and functional, this room can be divided into two separate spaces for parallel sessions. High quality finishings and furniture throughout the room with soundproof and sound-absorbing beech wood walls and cherry wood floors. Standard, ready to go set up and lay out.

Thonet linking lecture chairs with maximum comfort can be provided.

The room is located on the first floor.

FEATURES:

- Soundproof and sound-absorbing full height beech wood partition walls can divide the room into 2 separate spaces
- Natural light and remote controlled blackout facilities
- Dimmer lights for selected areas
- Standard 2 x 6 m stage with Presidential table and podium
- Lighting truss system for stage with dimmer lights
- Audio amplification system with wired and radio microphones
- Suspended video projection system suitable for various formats for every part of the room
- Front projection system in various sizes and video projector for every part of the room
- 2 component video cameras and 2 video composite cameras
- Extensive audio, video and lighting connections
- Mobile video production
- Simultaneous translation service with up to 16 languages
- High density Wi-Fi coverage
- LCD monitor on both Presidential table and podium
- 2 entrance points to the room
- Customisable digital signage at each entrance to room

The origin of the name

The Ponte Room takes its name from the Tiberius Bridge that was built during the rule of Augustus and Tiberius (14 - 21 A.D) and has long been admired by visitors to the city. Andrea Palladio refers to the bridge in his famous essay on architecture in 1570 as being "the most beautiful and most worthy of consideration both for its strength and its compartment". The monument stands out for the remarkable geometry of its arches, which reflect the water below, making a perfect circle, and for its robust structure softened by simple decorative elements. Up until the 20th century, it was the only link between the quaint fishing village of San Giuliano, that had developed on both sides of the Via Emilia since Roman times.

PONTE ROOM

FIRST FLOOR

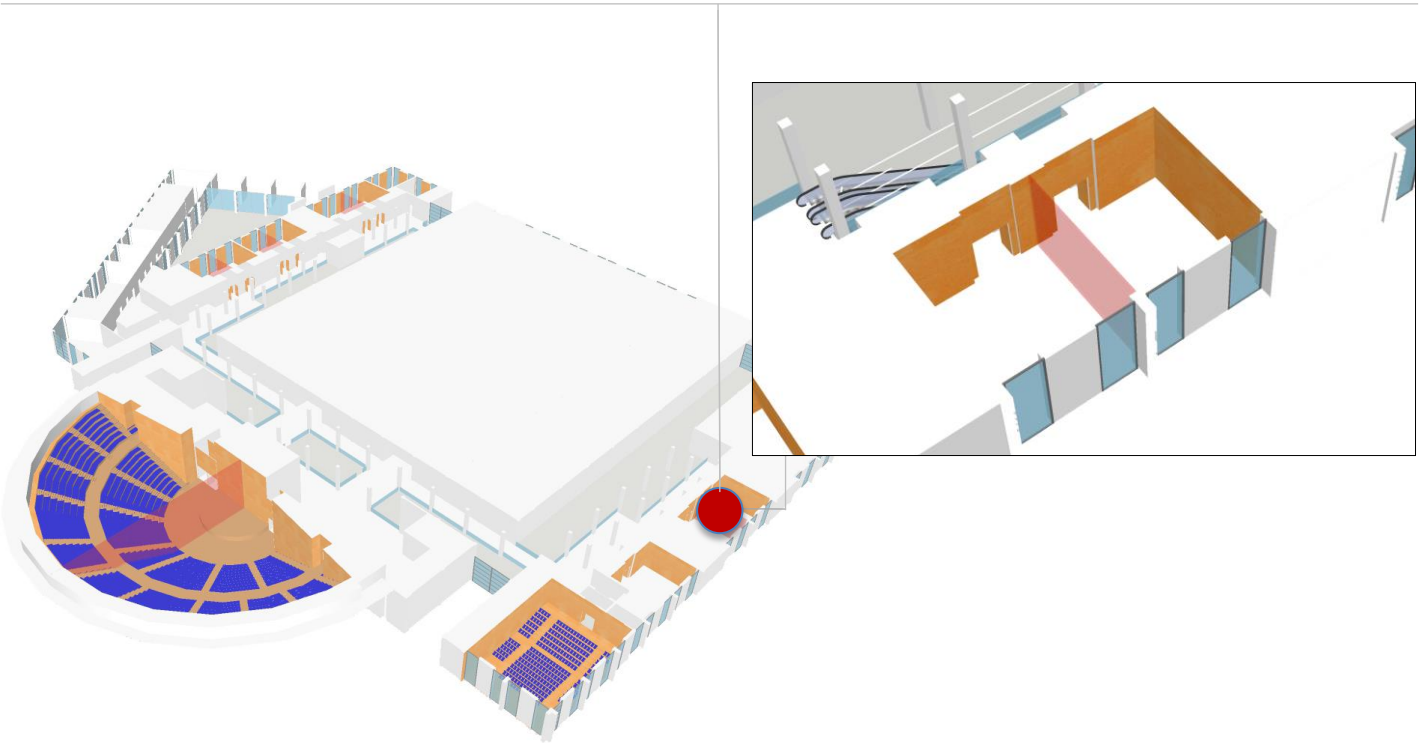

TECHNICAL DATA

| | Height (m) | Area m2 | Size (m) | Full room capacity | Classroom style | Horseshoe style | Boardroom style | Table service | Cocktail service |
|--------------|------------|---------|--------------|--------------------|-----------------|-----------------|-----------------|---------------|------------------|
| Full room | 4.20 | 133.80 | 15.20 x 8.80 | 110 | 64 | 35 | 40 | 80 | 110 |
| Ponte Room 1 | 4.20 | 66.85 | 7.55x8.80 | 44 | 24 | 15 | 18 | 32 | 55 |
| Ponte Room 2 | 4.20 | 66.85 | 7.55x8.80 | 44 | 24 | 15 | 18 | 32 | 55 |

TECHNICAL INFORMATION

| Floor weight capacity | Hanging fixtures permitted | Flooring | Walls | Ceiling | Natural light | Blackout facilities |
|-----------------------|----------------------------|------------------|------------------|----------------------------|---------------|---------------------|
| 400 | YES | DARK CHERRY WOOD | LIGHT BEECH WOOD | PIERCED WHITE PLASTERBOARD | YES | YES |

VIRTUAL TOUR LINK - take a 360° virtual tour of the Ponte Room at <https://en.riminipalacongressi.it/spaces/virtual-tour>

PONTE ROOM

FIRST FLOOR

PHOTOGALLERY

