



PALACONGRESSI  
DI RIMINI

# BASTIONI ROOM

TECHNICAL SHEET





## MAIN CHARACTERISTICS

Situated in a reserved area of the venue, this room can be used as a back office for the administrative or operational activities of conferences/events, such as secretariat, production office, staffroom or for board, committee or presidential meetings. Standard, ready to go set up and lay out. Thonet linking lecture chairs with maximum comfort can be provided. The room is located on the first floor.

## FEATURES:

- Natural light and remote controlled blackout facilities
- Dimmer lights for selected areas
- Presidential table and podium
- Audio amplification system with wired and radio microphones
- Suspended video projection system suitable for various formats in every part of the room
- Front projection system in various sizes and video projector
- 1 component video camera
- Extensive audio, video and lighting connections
- Mobile video production
- High density Wi-Fi coverage
- LCD monitor on both Presidential table and podium
- 2 entrance points to the room
- Customisable digital signage at entrance to room

### **The origin of the name**

The Bastioni Room takes its name from the remains of the old city walls, which are still visible in many areas of the city. A series of curtain walls and towers closed off the centre of the town, preventing it from enemy attacks. As was the case in many Italian cities, these walls were knocked down in the 19th century to allow roads to reach the city. The materials and forms used bear witness to the period of construction. The large blocks of local stone found at the base of the Arch of Augustus are from the ancient Roman era, whereas the bricks are of the Late-Antiquity, Medieval and Renaissance periods. The city was accessed by fortified doors which were closed every evening: still standing today are two from the Roman period - the Arch of Augustus and Porta Montanara - and some from Medieval times.

# BASTIONI ROOM

FIRST FLOOR

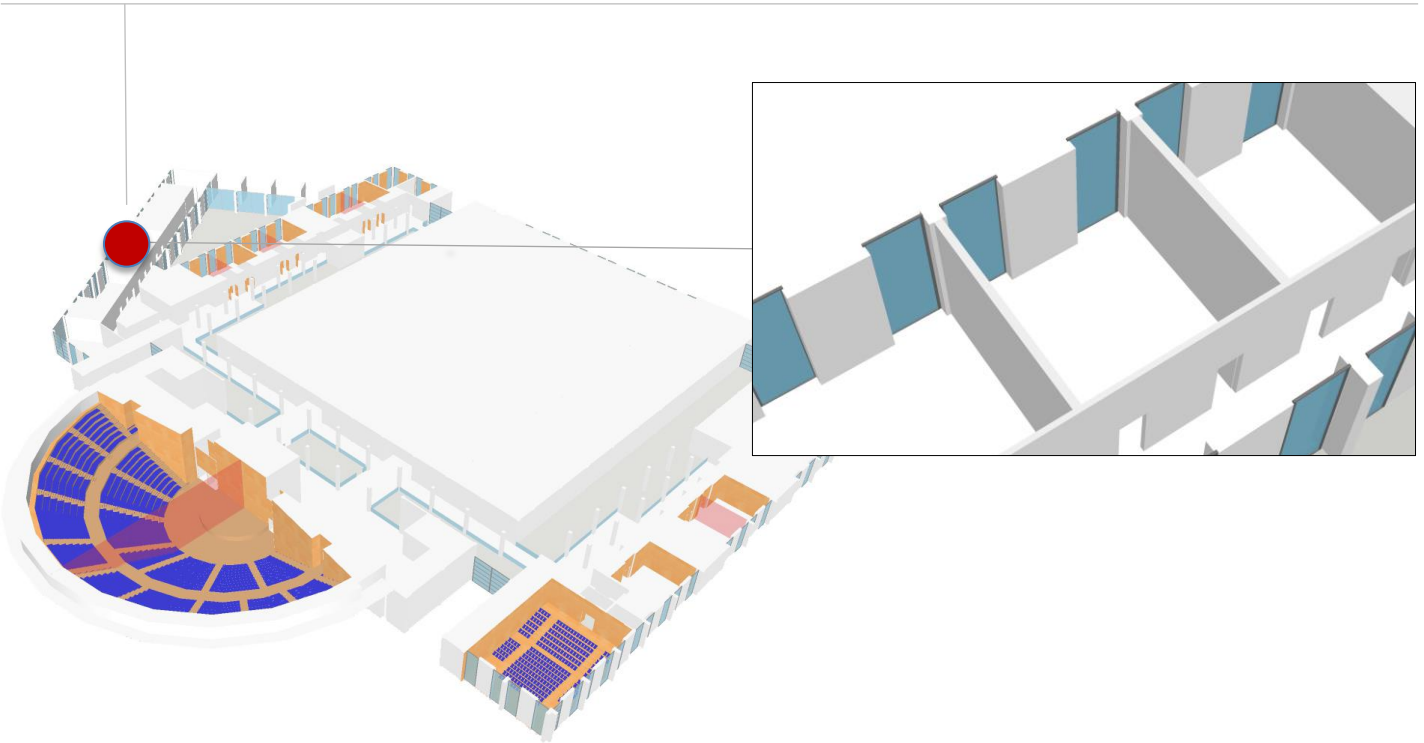

## TECHNICAL DATA

Height (m)	Area m2	Size (m)	Full room capacity	Classroom style	Horseshoe style	Boardroom style	Table service	Cocktail service
4.20	61.15	7.50 x 8.15	40	21	15	20	32	50

## TECHNICAL INFORMATION

Floor weight capacity	Hanging fixtures permitted	Flooring	Walls	Ceiling	Natural light	Blackout facilities
400	YES	DARK CHERRY WOOD	WHITE	PIERCED WHITE PLASTERBOARD	YES	YES

VIRTUAL TOUR LINK - take a 360° virtual tour of the Bastioni Room at <https://en.riminipalacongressi.it/spaces/virtual-tour>