

# CASTELLO ROOM

TECHNICAL SHEET







## MAIN CHARACTERISTICS

Elegant and functional, this room can be divided into two separate spaces for parallel sessions. High quality finishings and furniture throughout the room with soundproof and sound-absorbing beech wood walls and cherry wood floors. Standard, ready to go set up and lay out. Thonet linking lecture chairs with maximum comfort can be provided. The room is located on the ground floor.

## FEATURES:

- Soundproof and sound-absorbing full height beech wood partition walls can divide the room into 2 separate spaces
- Natural light and remote controlled blackout facilities
- Dimmer lights for selected areas
- Standard 2 x 10 m stage with Presidential table and podium
- Stage lighting truss system with stage dimmer lights
- Audio amplification system with wired and radio microphones
- Screen and hanging video projection system for front screen projection in every part of the room
- Fixed hooks for suspended rigging
- Extensive audio, video and lighting connections
- Fixed and mobile video production
- 3 translation booths with simultaneous translation service of up to 8 languages
- High density Wi-Fi coverage
- LCD monitor on both Presidential table and podium
- 2 entrance points to the room
- Customisable digital signage at each entrance to room
- Floor outlets for exhibitions (power supply, sockets)

## PROJECT IMPLEMENTATION AND DEVELOPMENT ON REQUEST:

- Other set-up options available based on feasibility

### The origin of the name

The Castello Room takes its name from Castel Sismondo, the residence of the most important member of the Malatesta family, Sigismondo Pandolfo (1419-1468). A brilliant leader, he was the patron of many artists and scholars. He enlisted the help of the renowned Filippo Brunelleschi to transform the stronghold of his ancestors into a formidable fortified construction, capable of withstanding bombardments. The tower still bears a magnificent coat of arms with a crest depicting an elephant against a chequered background. Together with the colourful majolica frieze of roses on another tower, these symbols bear witness to the House of Malatesta, Lords of Rimini from the late 13th to the early 16th century.

# CASTELLO ROOM

GROUND FLOOR

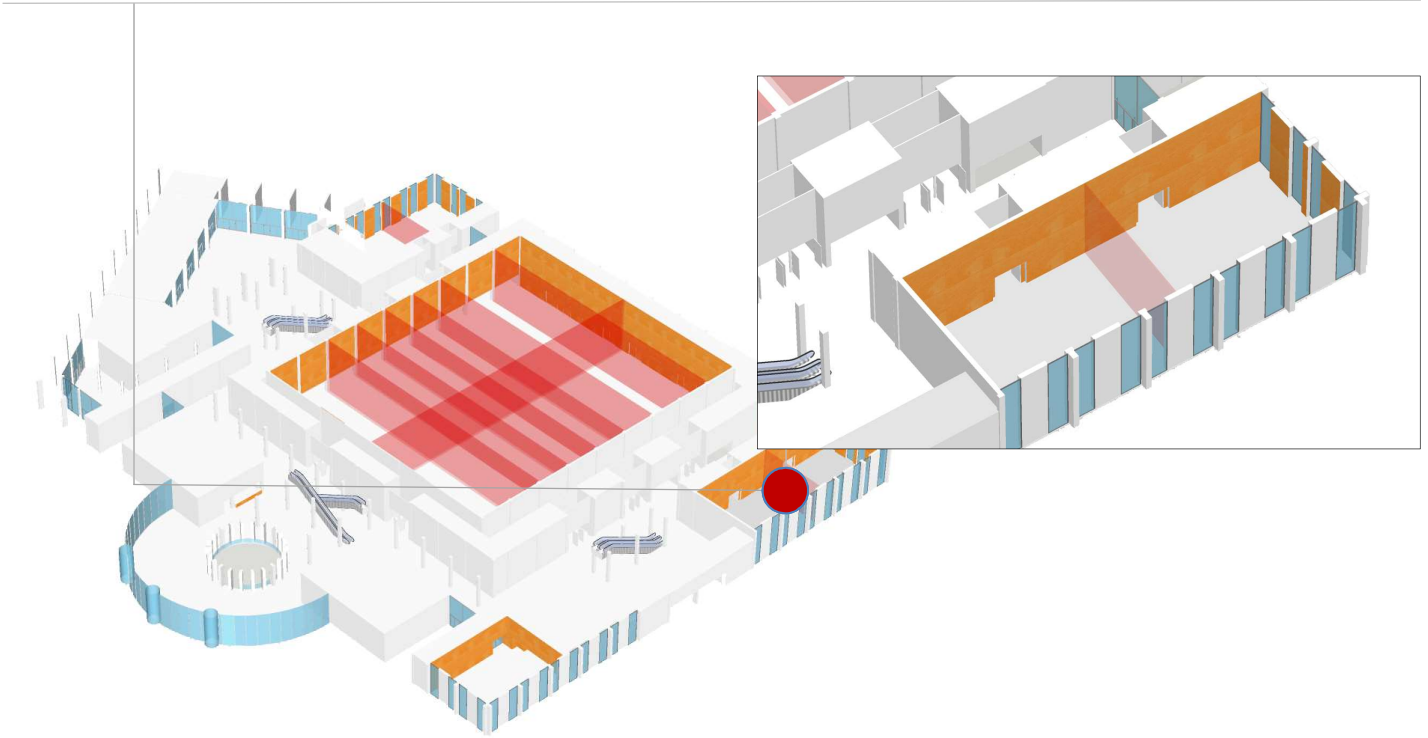

## TECHNICAL DATA

	Height (m)	Area m2	Size (m)	Full room capacity	Classroom style	Horseshoe style	Boardroom style	Table service	Cocktail service
Full room	8	576	38.40x15	580	308	-	-	384	480
Castello Room 1	8	287	19.10x15	260	126	55	70	192	240
Castello Room 2	8	287	19.10x15	260	126	55	70	192	240

## TECHNICAL INFORMATION

Floor weight capacity	Hanging fixtures permitted	Flooring	Walls	Ceiling	Natural light	Blackout facilities
2,000	YES	DARK CHERRY WOOD	LIGHT BEECH WOOD	STRETCHED METAL MESH SOUND-ABSORBING AND SOUND REFLECTING + PERIMETRAL SOUND-ABSORBING PLASTERBOARD	YES	YES

VIRTUAL TOUR LINK - take a 360° virtual tour of the Castello Room at <https://en.riminipalacongressi.it/spaces/virtual-tour>

Palacongressi di Rimini - Via della Fiera 23 - 47923 Rimini - Italy - Tel +39 0541 711500 - Fax +39 0541 711505  
info@riminipalacongressi.it - www.riminipalacongressi.it



# CASTELLO ROOM

GROUND FLOOR

## PHOTOGALLERY

